



# Derungs Hospital Room and Facility Lighting

*In the right light.*



A Division of Waldmann Lighting

## Spotlighting a History in the Making – Derungs and Waldmann

Two companies – 120 years experience. With Derungs' stellar market position as a top manufacturer of medical lighting, and Waldmann's unsurpassed leadership in providing superior task lighting solutions to virtually every type of workplace – the performance rightfully expected and demanded by medical providers is delivered. A complete line of top quality medical lighting – backed by our industry-best 10-year warranty – is born.

The Derungs hospital room and facility lighting line from Waldmann has been engineered especially for use in clinical areas, where safety and trouble-free function for the patients and hospital staff is not only necessary, but expected. Understanding the importance of providing healthcare facilities with reliable and sturdy, yet comfortable and attractive lighting, we manufacture our lights from durable materials and ensure they provide even, glare-free illumination within a stylish design.



*In the right light.*

 **Derungs**<sup>®</sup>  
Medical Lighting

A Division of Waldmann Lighting

# Feel the Comfort of Our Hospital Room and Facility Lighting



The Medicool E is offered in flexible gooseneck arm and articulated arm styles to accommodate a myriad of medical environments.



## Medicool E with Electronic Ballast – Providing Sight, Day or Night

The Medicool E bedside light features an ergonomically shaped head that rotates 270°. A unique control handle with illuminated strips on the sides assists the patient in finding the switch and orientating the light's position conveniently and quickly. Electronic ballasts are built into the Medicool E to eliminate flickering, reduce energy consumption and extend lamp life. Cool to the touch, this light includes an anti-glare diffuser lens to provide soft, soothing, uniform illumination that's appreciated by both patients and hospital staff. The Medicool E includes a 13-watt compact fluorescent lamp which offers virtually the same light output as a 60-watt incandescent bulb yet provides 20% less heat. Choose from a full range of mounting options, including those for head of the bed wall systems.



The Medicool E, shown on a bed rail mount, conveniently adjusts to your needs.



The Madeira with twin vertical arm clamps easily onto a table.



The sleek single arm Madeira provides a glare-free working environment.

### Madeira Adjustable Task Light – Shedding Light on the Situation

The compact Madeira features a rotational ball joint that allows the head to tilt up to 180° for greater control over direct illumination – an important benefit in many healthcare facility environments. For doctors' offices, it is just as critical for the doctor to see a patient's chart for evaluations as it is that they see the patient during an appointment. In a reception area, the Madeira provides even light to work surfaces and prevents glaring on VDT screens.

With a streamlined design and unique aluminized parabolic louver that directs light specifically to areas that need illumination, the Madeira's sleek head is easily and precisely adjusted to properly illuminate tasks such as reviewing test results. An energy-efficient 18-watt, compact fluorescent flat lamp is cool to the touch, and provides 10,000 hours of lamp life, 1100 lumen output and a 4100K color temperature.

The articulated arm on the Madeira comes in three styles: the single vertical arm is perfect for lighting smaller work surfaces; the twin vertical and twin horizontal arms permit effective positioning over larger work surfaces. The Madeira mounts on a table clamp, wall bracket, table base or panel brackets that fit various furniture manufacturers.

## Mounting Options and Accessories



**Wall Bracket:** Wherever you need it, Derungs medical lighting can be mounted there. (Medicool E, Madeira)



**Wall Bracket:** For stationary installations. (Medicool E, Madeira)



**Table Clamp:** Standard clamp for anchoring your light to virtually any table. (Medicool E, Madeira)



**Rail Clamp:** Keep your light close using the rail clamp for bedside installation – aluminum profiles. (Medicool E)



**Pin Mount Table Base:** Accommodates lights for steady tabletop use. (Medicool E, Madeira)



**Single Arm Table Base:** Your table is ready – secure tabletop mount. (Madeira)

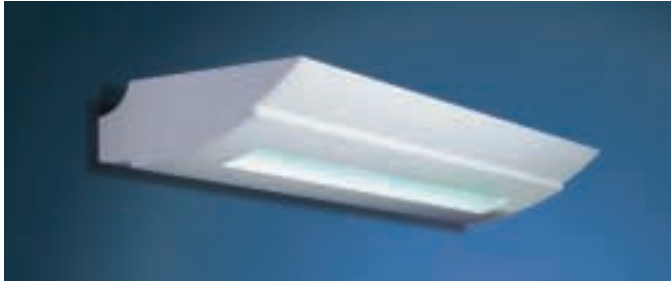
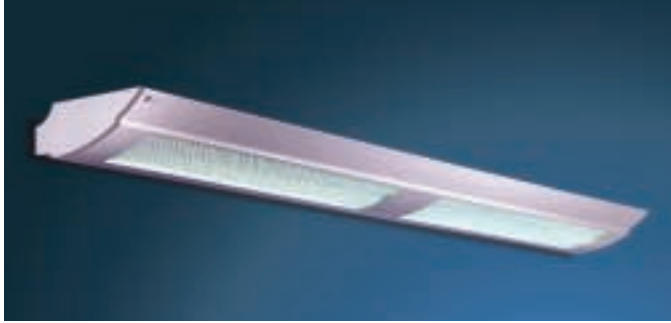

Ergolite wall sconces gently illuminate a variety of areas including hallways and lobbies.

### Ergolite Wall Sconces – Creating a Room with a View

Whether the need is for lighting the patient's room or the waiting room, the Ergolite is sure to provide the appropriate illumination level. This stylishly designed wall sconce comes in models that provide upward lighting, or upward and downward lighting settings that can be utilized separately or in combination to illuminate the room for checking a patient's vitals, reading or resting. The Ergolite also features built-in electronic ballasts that allow flicker-free light, reduced energy consumption and extended lamp life. Compact fluorescent lamps in conjunction with anti-glare diffuser lenses, create an even, soft and cool light output. Available with 40-watt compact fluorescent up-lighter, 40-watt compact fluorescent up-lighter and 13-watt compact fluorescent down-lighter, or double 40-watt compact fluorescent combined up-lighters and down-lighters.



**Fluorescent Lamps:**  
The source of quality illumination within the medical industry.

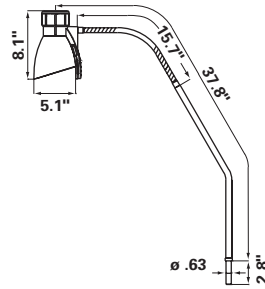

Medicool E (gooseneck arm)

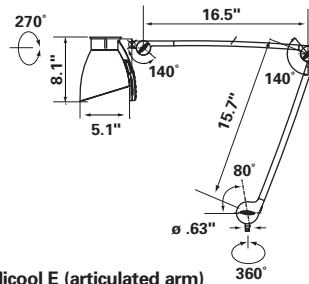

Medicool E (articulated arm)

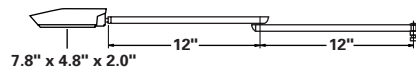

Madeira (twin horizontal arm)

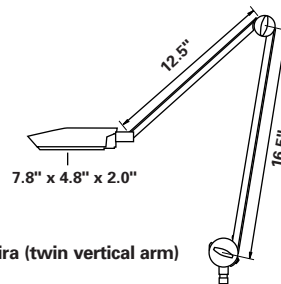

Madeira (twin vertical arm)

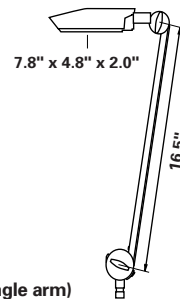

Madeira (single arm)

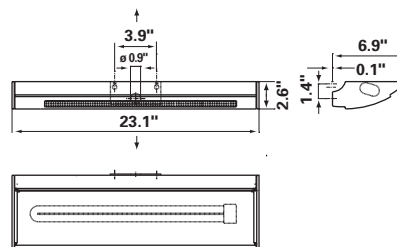

Ergolite 140

## Ordering Information

Name	Specifications	Order No.
Medicool E S3, 16 mm Gooseneck Arm	13-watt compact fluorescent lamp, control handle with switch and illuminated strips reach: 29.5" (750 mm) stem: 0.71" (16 mm) dia.	D13-112-000
Medicool E F1, 16 mm Articulated Arm	13-watt compact fluorescent lamp, control handle with switch and illuminated strips reach: 39.4" (1000 mm) stem: 0.63" (16 mm) dia.	D13-111-000
Madeira Single Vertical Arm	head: 7.8 x 4.8 x 2.0" (199 x 122 x 51 mm) arm: 16.5" (419 mm)	138-423-022
Madeira Twin Vertical Arm	head: 7.8 x 4.8 x 2.0" (199 x 122 x 51 mm) arm 1: 16.5" (419 mm); arm 2: 12.5" (317 mm)	138-421-022
Madeira Twin Horizontal Arm	head: 7.8 x 4.8 x 2.0" (199 x 122 x 51 mm) arm 1: 12" (305 mm); arm 2: 12" (305 mm)	138-422-022
Ergolite 140 Wall Sconce	compact fluorescent lamp: 40-watt up-lighter 24.4 x 6.9" (620 x 175 mm)	D13-300-000
Ergolite 140/13W Wall Sconce	compact fluorescent lamps: 40-watt up-lighter, 13-watt down-lighter for remote switching 26 x 6.9" (660 x 175 mm)	D13-302-000
Ergolite 240 Wall Sconce	double compact fluorescent lamps: one 40-watt up-lighter, one 40-watt down-lighter for remote switching 48 x 6.9" (1220 x 175 mm)	D13-301-000
<b>Replacement Lamps</b>		
Medicool E	compact fluorescent, 13-watt, 3500K	D68-837-000
Madeira (Standard)	compact fluorescent, 18-watt, 4100K	450-018-162
Ergolite Models	compact fluorescent, 40-watt, PL-L, 4100K	950-900-220
Ergolite 140/13W	compact fluorescent, 13-watt, T-2, 4100K	USO-252-013

For additional Medicool models, please see the Derungs/Waldmann comprehensive price list, or call 800.634.0007.

## Mounting Options

Type		Fits these Models	Order No.
Wall Bracket:	2.4 x 2.8 x 3.8" (60 x 70 x 95 mm)	Medicool E, Madeira	308-218-059
Wall Bracket:	4.3 x 1.5 x 2.1" (110 x 40 x 54 mm)	Medicool E, Madeira	D10-689-000
Table Clamp for Rounded Surfaces (not pictured):	2.4 x 3.5 x 2.3-2.8" (10-70 mm)	Madeira	191-017-029
Table Clamp, 16 mm:	0-2.75" (10-70 mm)	Medicool E, Madeira	200-498-069
Rail Clamp, 16 mm:	1-1.4" x .3-.4" (25-35 mm x 8-10 mm)	Medicool E	D13-269-000
Pin Mount Table Base:	12 x 9.5 x 1.5" (305 x 241 x 38 mm)	Medicool E, Madeira	190-112-069
Single Arm Table Base:	7.8 radius x 1.5" (197 x 38 mm)	Madeira – single arm	190-101-029
Panel Brackets (not pictured)		Madeira	Specify furniture system

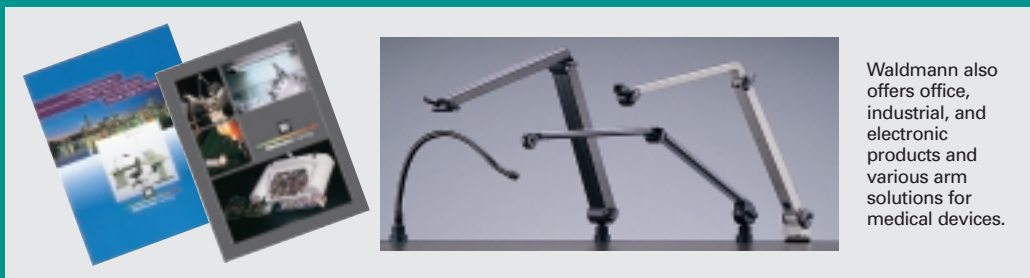

Waldmann also offers office, industrial, and electronic products and various arm solutions for medical devices.

Derungs will see you now... for your local Derungs/Waldmann distributor, call 800.634.0007, or visit us on Waldmann's Web site at [www.waldmannlighting.com](http://www.waldmannlighting.com).

**Derungs**<sup>®</sup>  
Medical Lighting

A Division of Waldmann Lighting



9 West Century Drive • Wheeling, IL 60090 • 847.520.1060 • Fax: 847.520.1730 • E-mail: [waldmann@waldmannlighting.com](mailto:waldmann@waldmannlighting.com)

©2000 Waldmann Lighting Co. 82-0200-5