

## LARGE AND SMALL HALOGEN SERIES

WALDMANN HALOGEN LUMINAIRES ARE SUPERIOR IN DESIGN CONSTRUCTION AND EFFICIENCY. AMONG THE MOST POPULAR IS THE HI-20 SERIES (SHOWN BELOW). THE DESIGN TAKES ADVANTAGE OF THE LATEST IN HALOGEN LAMP TECHNOLOGY AND ALLOWS FOR VARIETY IN BEAM ANGLES AND MOUNTING OPTIONS.



THE HI SERIES EASY LAMP CHANGE. NO TOOLS NECESSARY.



# HSW/HSWK-75: WATERPROOF LARGE HALOGEN



HSW-75 32" Arm

HSWK-75

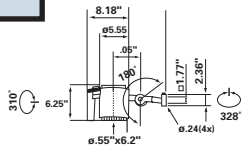

HSW front ring bayonet allows for quick and easy lamp replacement

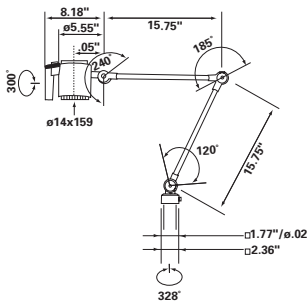

The HSW-75 waterproof halogen light delivers over 40% more light to the work surface than standard halogen lights by utilizing a 75-watt halogen lamp with a special reflector design. A glare-control, built-in louver minimizes harsh, unwanted glare. This luminaire works well in wet applications where coolants, oils and other fluids are prevalent.

## FEATURES:

- Heavy-duty 32" articulated arm provides easy adjustment.
- A front-ring bayonet connection allows the lens to twist off easily for fast lamp replacement, reducing machinery downtime.
- A 75-watt, 24V lamp and reflector design provides over 40% more light output than standard MR-16 halogens.
- A 4-hole mounting base is included for secure placement.
- Ergonomic thumb switch on head.
- IP65 waterproof protected.
- 12V models are available. Please contact Customer Service for additional information.

## ORDERING INFORMATION:

HSW-75, 24V, 32" arm, w/switch	112-185-010
Includes: 75-watt, 24V lamp, heat shield, built-in glare-control louver, clear glass lens, ergonomic thumb switch on head, electronic transformer (for 12V models).	
HSWK-75, 24V, w/o switch	112-187-013
HSWK-75, 24V, w/switch	112-187-010

## MOUNTING OPTIONS:

Clamp, 0"-2.75"	190-007-019
Clamp, 2.5"-5.3"	190-033-019
Wall Bracket	300-213-018

## REPLACEMENT PARTS:

Glass Lens, Clear	305-041-010
Lamp, Halogen, QT-LP12, 24V, 75W, GY6.35, 5-pack	320-283-060
Lamp, Halogen, QT-LP12, 12V, 75W, GY6.35, 5-pack	320-283-030
Electronic Transformer, 20-75 VA, 120-11.6V, 50/60Hz	US0-224-043

# HGW-70: WATERPROOF LARGE HALOGEN



HGW-70 with 32" Arm

HGW-70 with 18" Arm

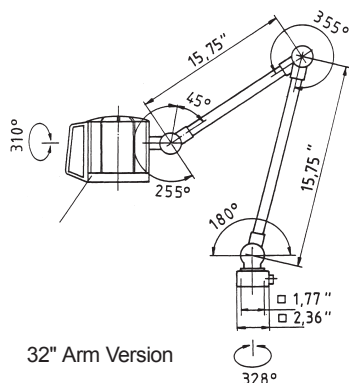

32" Arm Version

The HGW-70 machine light is the high powered solution for work areas requiring an intense light over longer distances. The 32" arm is available for maximum positioning. The 18" arm may be used in areas with less space. Both models include a double lens for heat reduction. This series of luminaires is ideal for large CNC machinery, conventional mills, lathes, and other metalworking machine tools where coolant, oil or other fluids are present.

## FEATURES:

- Ergonomic thumb switch on head.
- 60-watt halogen lamp provides high-intensity light with an est. lamp life of over 3500 hours.
- The ergonomically designed handle and heat shield attached to the head allows for safe and easy positioning.
- 4-hole mounting base is included.
- IP65 waterproof protected rating. UL and CUL listed.
- The 120V versions include a remote transformer in a waterproof case for plug-in to a 120V power supply.
- 12V models are available. Please contact Customer Service for additional information.

## ORDERING INFORMATION:

HGW-70, 120V, w/32" arm, in-line transformer	108-870-802
--	-------------

Includes: 60W, 24V lamp, heat shield, two hardened clear glass lenses for heat reduction, ergonomic thumb-switch on head, remote transformer mounted inside a waterproof metal case with 7.5' of cord to the light, and a 6' grounded cordset.

HGW-70, 120V, w/18" arm, in-line transformer	108-870-801
HGW-70, 24V, w/32" arm, with switch	100-870-803
HGW-70, 24V, w/18" arm, with switch	100-870-801

## MOUNTING OPTIONS:

Clamp, 0"-2.75"	190-007-019
Clamp, 2.5"-5.3"	190-033-019
Wall Bracket	300-213-018

## REPLACEMENT PARTS:

Lamp, Halogen, 24V, 60W, H3, 5-pack (24V and 120V models)	450-070-300
Lamp, Halogen, 12V, 55W, H3, 5-pack (HG/HGW 12V models)	450-055-300
Glass Lens, Hardened, Clear	305-412-010
Glass Lens, Tempered, Clear	305-412-030
Glass Lens, Hardened, Milky	305-412-020

# HGWK-70: WATERPROOF LARGE HALOGEN PIVOTING HEAD



HGWK-70

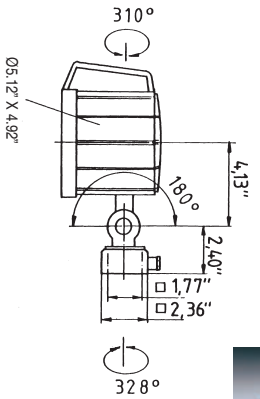

HGWK Transformers

The waterproof Pivoting Head version of our powerful HGW Halogen Series provides an intense light source where space is limited under harsh conditions.

## FEATURES:

- Compact head design for mounting in areas with restricted space.
- Extruded aluminum head helps dissipate heat build-up. Ergonomic handle and attached heat shield provide safe, easy positioning.
- All joints can be tightened to hold position during high vibration operations.
- The head has 3 adjustable positioning axes.
- IP65 waterproof rated. UL and CUL listed.
- A 5" head, side connection strain reliefs and a terminal block in the base allows for an easy connection.
- A 60-watt 24V halogen lamp is rated at 3500 hrs.
- Optional transformers are available either alone or mounted inside waterproof metal cases.
- A 4-hole mounting base is included.
- 12V models are available. Please contact Customer Service for additional information.

## ORDERING INFORMATION:

HGWK-70, 24V, without switch 008-308-800  
Includes: 60W, 24V lamp, hardened clear glass lens, and a 4-hole mounting base.  
HGWK-70, 24V, with ergonomic thumb-switch 008-308-802

## TRANSFORMERS:

With case:  
Transformer, enclosed, 60VA, 150-127-M19  
120-23.5V, 50/60Hz (HG 24V models)

Without case:  
Transformer, 60VA, 120-23.5V, 150-125-M19  
50/60Hz (HG 24V models)  
Transformer, 60VA, 230-23.5V, 150-048-019  
50/60Hz (HG 24V models)  
Electronic Transformer, 20-75VA, US0-224-043  
120-11.6V, 50/60Hz (HG 12V models)

## REPLACEMENT PARTS:

Lamp, Halogen, 24V, 60W, H3, 450-070-300  
5-pack (HG 24V and 120V models)  
Glass Lens, Hardened, Clear 305-412-010  
Glass Lens, Tempered, Clear 305-412-030  
Glass Lens, Hardened, Milky 305-412-020

# HG: DUSTPROOF LARGE HALOGEN ARTICULATING ARM



HG-55 32" Arm

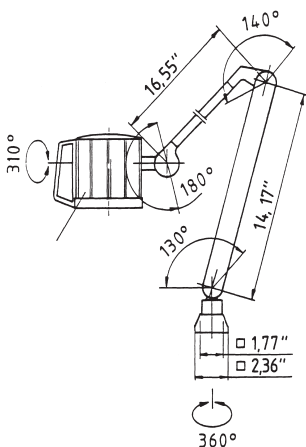

The HG-55 is the high powered solution for work areas requiring a broad, yet intense light over longer distances. It has a rugged 32" arm for easy positioning. This luminaire is commonly used where little or no fluid is present.

## FEATURES:

- A 55-watt halogen lamp provides high intensity light with an estimated lamp life of over 3500 hrs.
- A built-in louver directs light onto the work area and reduces glare.
- A built-in transformer in the lower arm allows convenient plug-in to a 120V power supply.
- The ergonomically designed heat shield attached to the head allows for easy positioning.
- With only 12V supplied to the head, operator safety is enhanced.
- IP20 dust-protected rating.
- The universal base allows the user the option to mount the light either vertically or horizontally.

## ORDERING INFORMATION:

HG-55, 120V 108-690-000  
(transformer built into arm)  
Includes: 55W, 12V lamp, clear glass lens, on/off rocker switch in arm, built-in glare-free louver, 6' cord with grounded plug, and built-in transformer in arm.

## MOUNTING OPTIONS:

Clamp, 0"-2.75" 190-007-019  
Clamp, 2.5"-5.3" 190-033-019

## REPLACEMENT PARTS:

Glass Lens, Hardened, Clear (HG series) 305-412-010  
Glass Lens, Tempered, Clear (HG series) 305-412-030  
Glass Lens, Hardened, Milky (HG series) 305-412-020  
Lamp, Halogen, 12V, 55W, H3, 5-pack (HG, HGW 12V models) 450-055-300  
Fuse, T0.5A, 12V, 55W, Halogen, 10-pack 950-900-057

# HI-20 SMALL HALOGEN SERIES

The HI-20 Series has been designed to take advantage of the latest halogen lamp technology and is available in several beam angles to accommodate your custom task light needs. The HI Series has a sturdy metal head, sealed for increased service life and protection from the environment. The ability to customize your beam angle and voltage, along with flexible mounting options offers enhanced productivity for your facility.

## FEATURES:

- 20-watt halogen lamp provides light for over 4,000 hours
- Quick and easy positioning
- Suitable for large or small work areas
- 10°, 24°, 38° and 60° beam angles
- Easy maintenance
- Strong, metal head construction
- Protective outer-head sleeve
- Integrated switch in luminaire head
- Flexible mounting options
- Large selection of accessories

## HI-20 SMALL HALOGEN ARTICULATING ARM

### FEATURES:

- Maximum working radius of 32"
- 5-axis arm movement
- Additional pivoting joint on the luminaire

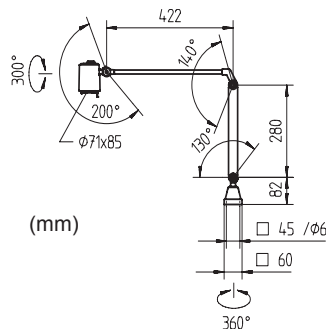

## HI-20 SMALL HALOGEN PIVOTING HEAD

### FEATURES:

- Ideal for permanent integration in machines
- Maximum versatility through pivoting head
- Flexible mounting using optional magnetic base

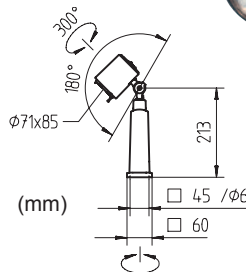

## HI-20 SMALL HALOGEN GOOSE-NECK ARM

### FEATURES:

- Maximum working radius of 24"
- Quick, precise movement
- Strong, durable arm

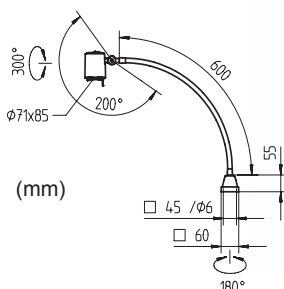

## ORDERING INFORMATION:

The following includes: IP20, 120V with Universal Base, 20W halogen lamp (please specify voltage), tempered glass lens, and a 24° beam.

Articulating Arm, plug-in transformer 112-417-061  
Articulating Arm, without transformer\* 112-416-065

Pivoting Head, plug-in transformer 112-419-061  
Pivoting Head, without transformer\* 112-418-065

Goose-neck Arm, plug-in transformer 112-415-081  
Goose-neck Arm, without transformer\* 112-414-085

\* Not supplied with a transformer

All also available in 10°, 38°, and 60°, beam angles. Please call Customer Service for details.

For 24V operation, you must use 320-724-010  
24V, 10° lamp

## MOUNTING OPTIONS:

Clamp, 0"-2.75" 190-007-019  
Clamp, 2.5"-5.3" 190-033-019  
Clamp, 3.7"-6.5" 190-035-019  
Table Base, Black 190-036-039  
1/2" Base Mount Adapter SK3-618-011  
Magnetic Base 190-057-019  
Wall Bracket 300-213-018

## ACCESSORIES:

Fiberoptic Tube 001-364-002  
Light Projector 000-364-000

## REPLACEMENT PARTS

Glass Lens, Clear 225-303-019

Lamp, MRC-16, 12V, 20W, 10° 320-471-010  
Lamp, MRC-16, 12V, 20W, 24° 320-471-020  
Lamp, MRC-16, 12V, 20W, 38° 320-471-030  
Lamp, MRC-16, 12V, 20W, 60° 320-471-040