

HG / HGW

LARGE HALOGEN SPOT



FEATURES:

- Halogen industrial task light designed for large machining areas
- Available in waterproof (HGW & HGWK) and non-waterproof models (HG)
- The ergonomically designed handle attached to the head allows for easy positioning
- Low voltage models require only 24V supplied to the lamp, improving operator safety
- 120V versions include a remote transformer in waterproof case for plug-in 120V operation
- Extruded aluminum ergonomic handle and heat shield provide safe, easy positioning
- All joints can be tightened to hold position during high vibration operations
- The head has 3 adjustable positioning axes
- A 5in head with side connection strain reliefs and terminal block, insure easy installation
- Optional transformers are available either alone or mounted inside waterproof cases
- 4-hole mounting base included
- 12V models are available. Please contact Customer Service for additional information.

PRODUCT DESCRIPTION:

When a powerful halogen spot light is required on machinery, Waldmann halogen luminaires are the perfect solution. The HG and HGW Series of halogen luminaires offer a concentrated, intense light beam for your larger machining areas. With a whole range of useful features, the HG and HGW make the work process simpler, faster and more cost-effective. The safety risk of glare is particularly high with strong halogen light and glare should be minimized whenever possible. The ingenious anti-

glare louver in the HG and HGW head prevents glare from bothering co-workers. The HGW-70 machine light is the high powered solution for work areas requiring an intense light over longer distances. The 32" arm is available for maximum positioning. The 18" arm may be used in areas with less space. Both models include a double lens for heat reduction. This series of luminaires is ideal for large CNC machinery, conventional mills, lathes, and other metalworking machine tools where coolant, oil or other fluids are present. The waterproof pivoting head version of our power-

ful HGW halogen series provides an intense light source where space is limited under harsh conditions. The HG-55 is the high powered solution for work areas requiring a broad, yet intense light that is commonly used where little or no fluid is present. It has a rugged 32" arm for easy positioning. The HGW-70 halogen luminaire with a protection rating of IP65 provides light just where it's needed with pinpoint accuracy. Glare-free and user-friendly, the HG and HGW Series offer versatile, functional and quality lighting for many industrial machines.

PRODUCT INFORMATION



HGWK PIVOTING HEAD



HG OR HGW ARTICULATING ARM

Voltage:	24V or 120V, 50/60Hz
Lamping:	55W or 60W halogen
Luminaire Body:	Extruded aluminum head, powder-coated steel arm
Operation:	Most models available with or without switch
Lens Cover:	Borosilicate glass
Protection Rating:	HG - IP20 HGW - IP65 w/switch HGW - IP67 without switch
Cord Length:	10ft (3m)

ORDERING INFORMATION

DESCRIPTION	WATTAGE	VOLTAGE	SWITCH	IP RATING	MODEL	PART #
Articulating Arm	55W	120V	Yes	IP20	HG-55	108 690 000
Pivoting Head, w/switch	60W	24V	Yes	IP65	HGWK-70	008 308 802
Pivoting Head, no switch	60W	24V	No	IP67	HGWK-70	008 308 800
Articulating Arm, 18"	60W	24V	Yes	IP65	HGW-70	100 870 801
Articulating Arm, 32"	60W	24V	Yes	IP65	HGW-70	100 870 803
Articulating Arm, 18", in-line transformer	60W	120V	Yes	IP65	HGW-70	108 870 801
Articulating Arm, 32", in-line transformer	60W	120V	Yes	IP65	HGW-70	108 870 802

For mounting options see page 41

ACCESSORIES

DESCRIPTION	PART #
Replacement Lamp, halogen, 55W, 12V, H3 (Fits HG-55 120V models with 12V transformer only)	450 055 300
Replacement Lamp, halogen, 60W, 24V, H3, (Fits all HGW 24V and 120V models)	450 070 300
Transformer, enclosed w/case, 60VA, 120V, 50/60Hz, input to 24V output (For use with all HGW 24V models)	150 127 M19
Transformer, without case, 60VA, 120V 50/60Hz, input to 24V output (For use with all HG & HGW 24V models)	150 125 M19
Transformer, without case, 60VA, 230V 50/60Hz, input to 24V output (For use with all HG & HGW 24V models)	150 048 019
Replacement Lens, hardened glass, clear (For use with all HG & HGW models)	305 412 010
Replacement Lens, tempered glass, clear (For use with HG & HGW models)	305 412 030
Replacement Lens, hardened glass, frosted (For use with all HG & HGW models)	305 412 020
Fuse, T0.5A, 12V, 55W, (For use only with HG 12V models)	950 900 057

DIMENSIONAL DATA

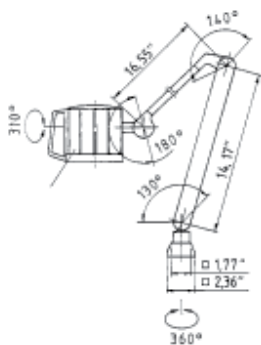

HG ARTICULATING ARM

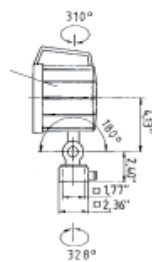

HGWK PIVOTING HEAD

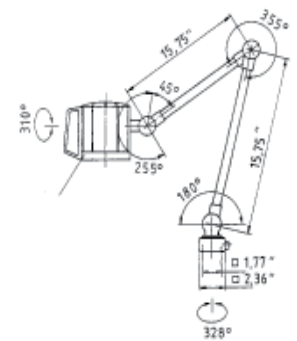

HGW ARTICULATING ARM