

Waldmann **W**

ENGINEER OF LIGHT.

LIGHTING FOR VETERINARY MEDICINE
SOLUTIONS FOR HOSPITALS AND CLINICS



YOU HAVE A PASSION FOR ANIMALS WE HAVE A PASSION FOR GREAT LIGHTING

While you take care of your patients, we take care of you. Optimal lighting is a very important component in the everyday operation of a veterinary facility.

Waldmann Lighting and its medical division, Derungs Medical Lighting, offer premium quality materials, meticulous workmanship and state of the art design. Our products are held to the highest standards and have become synonymous with the exceptional Swiss level of quality.



Derungs is a division of the Waldmann Group specializing in design solutions for the healthcare sector. We have been developing and producing high-quality lighting solutions for over 75 years. Waldmann Lighting's sales representatives are happy to provide consultation regarding specific applications or product inquiries.



DISCOVER SMART LED SOLUTIONS FOR YOUR VET PRACTICE

FIND YOUR IDEAL SURGERY AND EXAM LIGHT

Triango 100 LED Surgery Light Series offers many benefits for both the practitioner and patient. The unique concave shape allows the physician to position the light directly above the patient. This design minimizes shadowing that may occur from the practitioner's hands or equipment. Triango 100 also features a specially designed spring arm system for flexible movement in all directions as well as the ability to fold down tight for storage. Triango 100 can also boast optimum light conditions at 100,000 lux at 1 meter, and a precise color rendering of >95 as well as four dimming levels. In addition, special focusable models are available where specialties are practiced with specific needs.



TRIANGO 100 SURGERY LIGHT

- Light output - 100,000 lx / 1 m
- Light field - 7" / 1 m Optional: 7 - 11"
- Color temperature: 4300K (100-1 models)
Optional: 3700K, 4300K, 4700K (100-3 models)
- CRI >95
- Dual and single head mounts available
- Mounting options: ceiling*, wall or rolling stand
- 50,000 hours of LED life (L70)

- Electronics integrated for safety/energy efficiency
- Large turning radius and newly designed TENO arm system for easy positioning
- Sealed design for easy sanitizing
- Autoclavable handle (covers are also available)
- Simple operation with easy to reach keypad
- Diamond optic design reduces shadows

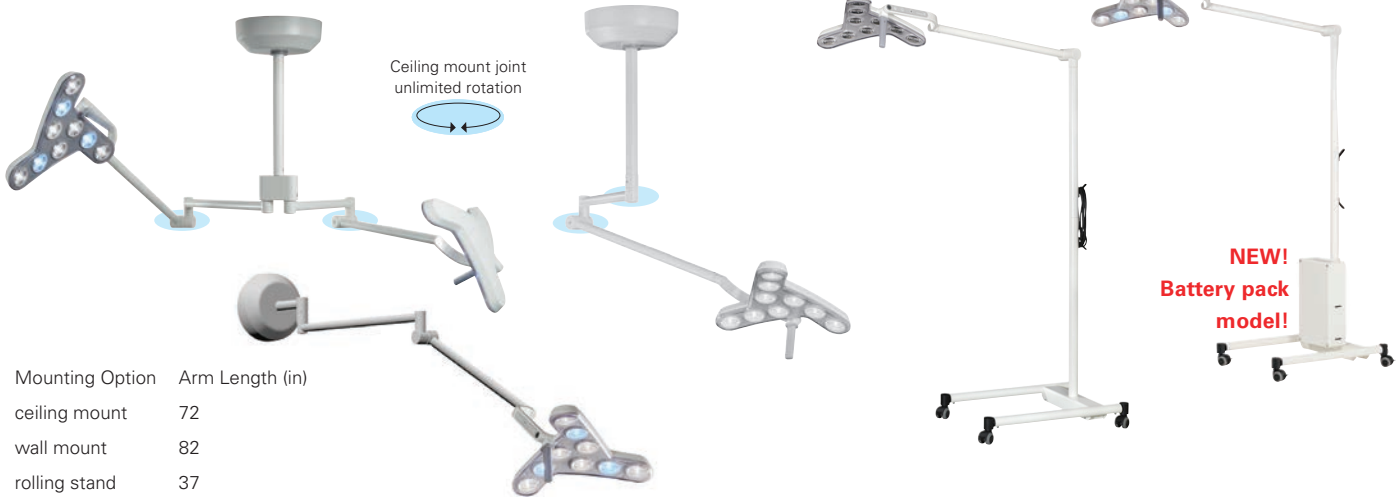

Mounting Option	Arm Length (in)
ceiling mount	72
wall mount	82
rolling stand	37

TRIANGO 80 SURGERY LIGHT

- Light output - 80,000 lx / 1 m
- Light field - 7" / 1 m
- Color temperature: 4500K
- CRI >95
- Single head mount
- Mounting options: ceiling*, wall or rolling stand
- 50,000 hours of LED life (L70)

- Continuously dimmable
- No heat directed at patient or practitioner
- Sealed design for easy sanitizing
- Autoclavable handle (covers are also available)
- High energy efficiency at 30W



Mounting Option	Arm Length (in)
ceiling mount	70
wall mount	80
rolling stand	37

TRIANGO 100, TRIANGO 80, TRIANGO 60
 Standards: ANSI/AAMI ES60601-1:2005 / EN/IEC 60601-1 / EN/IEC 60601-2-41 / EN/IEC 60601-1-2 / CAN/CSA-22.2 NO. 60601-1 / CAN/CSA-C22.2 NO 60601-2-41 / CAN/CSA-C22.2 NO. 60601-1-6
 Compliance: RoHS
 Conformity: CE
 Listed: MET/cMET

NEW!
TRIANGO 60
SURGERY LIGHT

- Light output - 60 000 lx at 1 m
- Light field - 7" / 1 m; Optional 7 - 10"
- Color temperature: 4700K
- Optional: 3700K, 4300K, 4700K
- CRI > 93
- Single head mount
- Mounting options: ceiling*, wall or rolling stand
- Continuously dimmable
- No heat directed at patient or practitioner
- Sealed design for easy sanitizing
- Autoclavable handle (covers are also available)
- Voltage 100-240 V; 50/60 Hz
- High energy efficiency at 30W



Mounting Option	Arm Length (in)
ceiling mount	68
wall mount	78
rolling stand	36

NEW!
TRIANGO
UPSmedpack

As an uninterrupted power supply (UPS), the battery unit ensures that the lighting can be used even in the event of a power failure or unstable power supply.



Display panel
Display with charging and warning messages (visual and acoustic)

High battery power
Long self-sufficiency time (4-7.5 h) with maintenance-free lead gel battery

Easy to clean
Resistant to cleaning agents, few openings, slim design

Roller stand
Bracket for mobile version of TRIANGO series

Ecology
Recyclable materials (lead acid batteries are 99% recycled)

User-friendly
UPSmed Pack is easy to understand via a display panel:

- Battery status
- Charge status
- Power status

Robust battery housing
Made of durable materials to ensure longer battery life and safe handling

Uninterruptible power supply
This battery unit is permanently connected between the mains supply and the luminaire. As soon as the mains supply becomes unstable or interrupts, or the mains supply is disconnected, the UPSmed Pack engages and the fixture continues to operate without any interruption.

*For 8-11.5' ceiling heights with field cuttable tube

EXAM LIGHTS

Waldmann Lighting examination lights offer a comprehensive range of benefits, thanks to our modern LED technologies. They provide a uniform, shadow-free light field ensuring optimal illumination of the examination area without emitting heat in the direction of the patient or practitioner. Illuminance levels of up to 60,000 lux at 0.5m and high color rendering guarantee the best working environment possible.



VISIANO 20-2 EXAM/DENTAL LIGHT

- Light output - 60,000 lx / 0.5 m
- Light field - 8.3" / 0.5 m
- Color temperatures: 3500K and 4500K
- CRI >95
- Mounting options: ceiling*, clamp, wall, rail or rolling stand
- 360° turning radius at the luminaire head
- Four dimming levels
- Ergonomic controls on head allow for one-handed operation
- Sealed design for easy sanitizing
- Electronics integrated for maximum safety and energy efficiency
- Strong, aluminum frame and spring-balanced friction joints
- Diamond optic design reduces shadows

VISIANO 10-1 COMPACT EXAMINATION LIGHT

- Light output - 50,000 lx / 0.5 m
- Light field - 7" / 0.5 m
- Color temperature: 4400K
- CRI >93
- Mounting options: clamp, wall, rail or rolling stand
- 280° turning radius at the luminaire head
- Ergonomic controls on head for one-handed operation
- Electronics integrated for safety and energy efficiency
- Ergonomic handle and high quality gooseneck arm for easy positioning
- Intuitive operation using I/O switch
- Sealed design for easy sanitizing
- Diamond optic design reduces shadows



VISIANO 20, VISIANO 10, OPTICLUX

Standards: ANSI/AAMI ES60601-1:2005 / EN/IEC 60601-1 / EN/IEC 60601-2-41 / EN/IEC 60601-1-2 / CAN/CSA-22.2 NO. 60601-1 / CAN/CSA-C22.2 NO 60601-2-41 / CAN/CSA-C22.2 NO. 60601-1-6

Compliance: RoHS

Conformity: CE

Listed: MET/cMET

www.waldmannlighting.com

*For 8-11.5' ceiling heights with field cuttable tube

MAGNIFIER WOOD'S LIGHT (UV) LUMINAIRES

SEE THINGS CLEARLY

Damage caused by bacteria, fungal infections, viruses or parasites can result in skin diseases that require treatment. In veterinary practices, magnifier Wood's light (UV) luminaires are routinely used to aid in diagnoses or in performing procedures such as removing foreign bodies or sutures from the skin.



OPTICLUX LED MAGNIFIER

- Color temperature daylight white 6500K
- Magnification 1.88x (3.5 diopters)
- 6.3" specially-treated hard acrylic magnifier lens with protective lens cover
- Color rendering properties: CRI >93, R9 >90, R13 >95
- Light field: 6,000 lux / 0.15 m; Hand held 8,000 lx / 0.15 m
- Continuously dimmable 100% of 10%
- Dimensions: Arm 43", head 11"
- Optional Wood's light: Peak at 365 nm
- Available as a ceiling version* and pin version with mounting accessories for walls, tables, rails and rolling floor stands
- Handheld Wood's light model available
- Optional handheld model charging station

*For 8-11.5' ceiling heights with field cuttable tube



ORDERING INFORMATION



TRIANGO 100

Part No	Model	Mounting	Color Temp	Wattage	Focusable
D16072000	TRIANGO LED 100-1 C	Ceiling	4300K	40W	No
D16205000	TRIANGO LED 100-1C Dual	Ceiling	4300K	40W x 2	No
D16075000	TRIANGO FOKUS LED 100-3 C	Ceiling	3700K/ 4300K/ 4700K	40W	Yes
D16206000	TRIANGO Fokus LED 100-3 C Dual	Ceiling	3700K/ 4300K/ 4700K	40W x 2	Yes
D15918000	TRIANGO Fokus LED 100-3 F	Rolling Stand	3700K/ 4300K/ 4700K	40W	Yes

TRIANGO 80

Part No	Model	Mounting Type	Color Temp	Wattage	Dimming Levels
D16138000	TRIANGO LED 80 C	Ceiling	4500K	30W	Continuous
D16139000	TRIANGO LED 80 W	Wall Mount	4500K	30W	Continuous
D16135000	TRIANGO LED 80 F	Rolling Stand	4500K	30W	Continuous

TRIANGO 60

Part No	Model	Mounting Type	Color Temp	Wattage	Dimming Levels
D16253000	TRIANGO 60-1 C	Ceiling	4700K	30W	Continuous
D16254000	TRIANGO 60-3 C	Ceiling	3700K / 4300K / 4700K	30W	Continuous
D16265000	TRIANGO 60-1 F	Rolling Stand	4700K	30W	Continuous
D16266000	TRIANGO 60-3 F	Rolling Stand	3700K / 4300K / 4700K	30W	Continuous
D16280000	TRIANGO 60-1 F	Rolling Stand	4700K	30W	Continuous
D16274000	TRIANGO 60-1 W	Wall	4700K	30W	Continuous

VISIANO 20

Part No	Model	Mounting Type	Color Temp	Wattage	Dimming Levels
D15461100	VISIANO 20-2 PTX	Clamp	3500K/4500K	21W	4
D15461150	VISIANO 20-2 PTX	Rail Mount	3500K/4500K	21W	4
D15461120	VISIANO 20-2 PTX	Wall Mount	3500K/4500K	21W	4
D15594000	VISIANO 20-2 CT1	Ceiling	3500K/4500K	21W	4
D15461110	VISIANO 20-2 PTX	Rolling Stand	3500K/4500K	21W	4

VISIANO 10

Part No	Model	Mounting Type	Color Temp	Wattage
D15757120	VISIANO 10-1 P S10	Wall Mount	4400K	13W
D15757150	VISIANO 10-1 P S10	Rail Mount	4400K	13W
D15757100	VISIANO 10-1 P S10	Clamp	4400K	13W
D15757110	VISIANO 10-1 P S10	Rolling Stand	4400K	13W

OPTICLUX

Part No	Model	Mounting Type	Special Features
D16071000	OPTICLUX 10-2 CT1	Ceiling	Wood's Light
D15953100	OPTICLUX 10-2 TX	Clamp	Wood's Light
D16067000	OPTICLUX Hand 10-2, UV - Handheld	Hand Held	Wood's Light

Additional models available. Visit www.waldmannlighting.com to find out more.

Waldmann Lighting Company

9 Century Drive
Wheeling, Illinois 60090
www.waldmannlighting.com

Telephone (847) 520 1060
Fax (847) 520 1730
waldmann@waldmannlighting.com



ENGINEER OF LIGHT.

368R.040124.RTS.