

---

**LIGHTING FOR VETERINARY MEDICINE**  
SOLUTIONS FOR HOSPITALS AND CLINICS

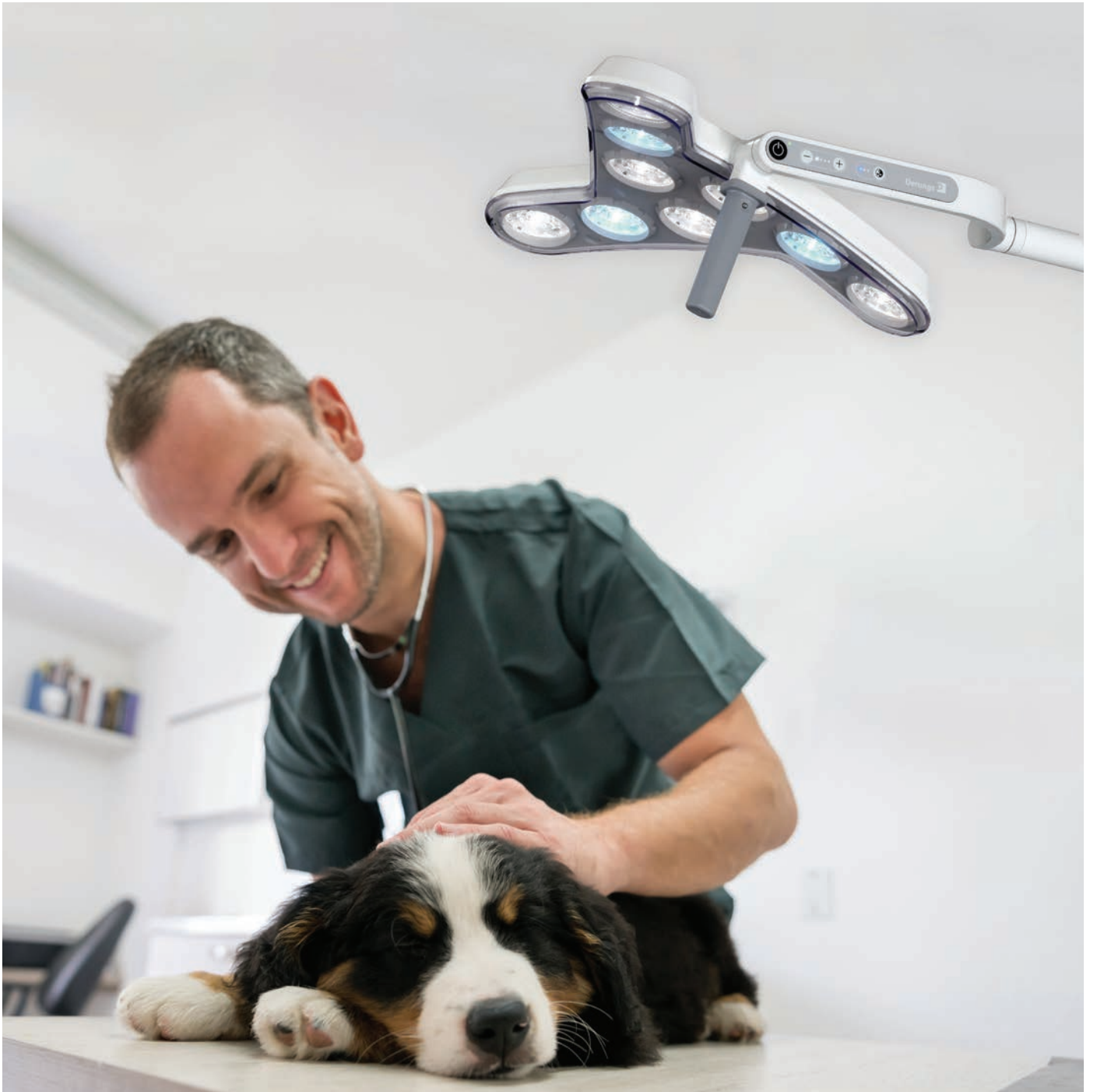

# YOU HAVE A PASSION FOR ANIMALS WE HAVE A PASSION FOR GREAT LIGHTING

While you take care of your patients, we take care of you. Optimal lighting is a very important component in the everyday operation of a veterinary facility.

Waldmann Lighting and its medical division, Derungs Medical Lighting, offer premium quality materials, meticulous workmanship and state of the art design. Our products are held to the highest standards and have become synonymous with the exceptional Swiss level of quality.



## SURGICAL LIGHTS

### LIGHTING FOR THE PERFECTIONIST

#### TRIANGO 100 SURGERY LIGHT



- Light output - 100,000 lx / 1 m
- Light field - 7" / 1 m Optional: 7 - 11"
- Color temperature: 4300K (100-1 models)  
Optional: 3700K, 4300K, 4700K (100-3 models)
- CRI >95
- Dual and single head mounts available
- Mounting options: ceiling\*, wall or rolling stand
- 50,000 hours of LED life (L70)
- Electronics integrated for safety/energy efficiency
- Large turning radius and newly designed TENO arm system for easy positioning
- Sealed design for easy sanitizing
- Autoclavable handle (covers are also available)
- Simple operation with easy to reach keypad
- Diamond optic design reduces shadows

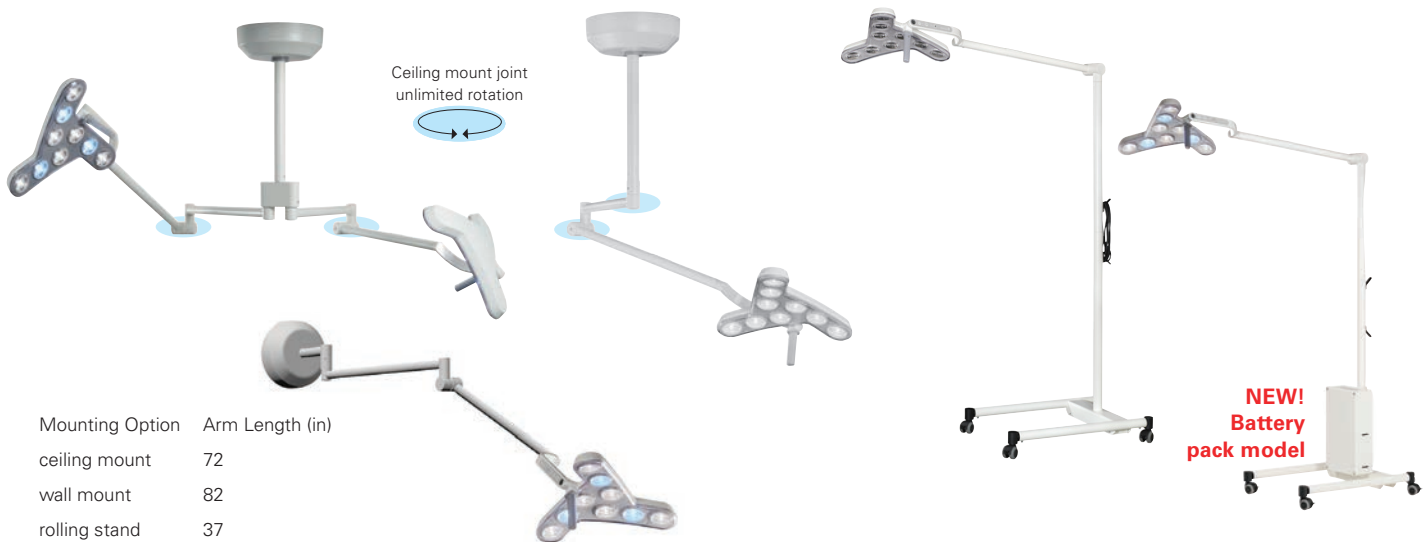

TRIANGO 100, TRIANGO 80, TRIANGO 60

Standards: ANSI/AAMI ES60601-1:2005 / EN/IEC 60601-1 / EN/IEC 60601-2-41 / EN/IEC 60601-1-2 / CAN/CSA-22.2 NO. 60601-1 / CAN/CSA-C22.2 NO 60601-2-41 / CAN/CSA-C22.2 NO. 60601-1-6

Compliance: RoHS

Conformity: CE

Listed: MET/cMET

[www.waldmannlighting.com](http://www.waldmannlighting.com)

\*For 8-11.5' ceiling heights with field cuttable tube

# TRIANGO 80 SURGERY LIGHT

- Light output - 80,000 lx / 1 m
- Light field - 7" / 1 m
- Color temperature: 4500K
- CRI >95
- Single head mount
- Mounting options: ceiling\*, wall or rolling stand

- 50,000 hours of LED life (L70)
- Continuously dimmable
- No heat directed at patient or practitioner
- Sealed design for easy sanitizing
- Autoclavable handle (covers are also available)
- High energy efficiency at 30W



Mounting Option	Arm Length (in)
ceiling mount	70
wall mount	80
rolling stand	37

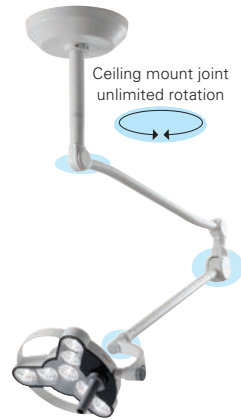

# NEW! TRIANGO 60 SURGERY LIGHT

- Light output - 60 000 lx at 1 m
- Light field - 7" / 1 m; Optional 7 - 10"
- Color temperature: 4700K
- Optional: 3700K, 4300K, 4700K
- CRI > 93
- Single head mount
- Mounting options: ceiling\*, wall or rolling stand
- Continuously dimmable
- No heat directed at patient or practitioner
- Sealed design for easy sanitizing
- Autoclavable handle (covers are also available)
- Voltage 100-240 V; 50/60 Hz
- High energy efficiency at 30W

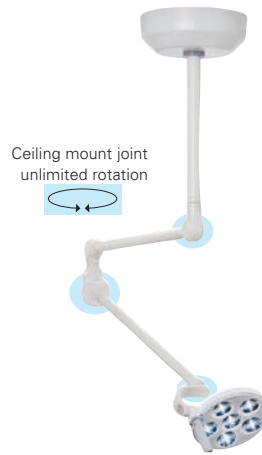

Mounting Option	Arm Length (in)
ceiling mount	68
wall mount	78
rolling stand	36

\*For 8-11.5' ceiling heights with field cuttable tube

**NEW!****TRIANGO**

## UPSmedpack

As an uninterrupted power supply (UPS), the battery unit ensures that the lighting can be used even in the event of a power failure or unstable power supply.

**Product highlights****Display panel**

Display with charging and warning messages (visual and acoustic)

**User-friendly**

UPSmed Pack is easy to understand via a display panel:

- Battery status
- Charge status
- Power status

**High battery power**

Long self-sufficiency time (4-7.5 h) with maintenance-free lead gel battery

**Robust battery housing**

Made of durable materials to ensure longer battery life and safe handling

**Easy to clean**

Resistant to cleaning agents, few openings, slim design

**Uninterruptible power supply**

This battery unit is permanently connected between the mains supply and the luminaire.

As soon as the mains supply becomes unstable or interrupts, or the the mains supply is disconnected, the UPSmed Pack engages and the fixture continues to operate without any interruption.

**Roller stand**

Bracket for mobile version of TRIANGO series

**Ecology**

Recyclable materials (lead acid batteries are 99% recycled)

## EXAMINATION AND PROCEDURE LIGHTS

### A COMPREHENSIVE RANGE

Professional examination and procedure lights offer a comprehensive range of benefits, thanks to modern LED technologies. They provide a uniform, shadow-free light field ensuring optimal illumination of the examination area without emitting heat in the direction of the patient or practitioner. Illuminance levels of up to 60,000 lux and high color rendering guarantee the best working environment possible.



### VISIANO 20-2 EXAM/DENTAL LIGHT

- Light output - 60,000 lx / 0.5 m
- Light field - 8.3" / 0.5 m
- Color temperatures: 3500K and 4500K
- CRI >95
- Mounting options: ceiling\*, clamp, wall, rail or rolling stand
- 360° turning radius at the luminaire head
- Four dimming levels
- Ergonomic controls on head allow for one-handed operation
- Sealed design for easy sanitizing
- Electronics integrated for maximum safety and energy efficiency
- Strong, aluminum frame and spring-balanced friction joints
- Diamond optic design reduces shadows

VISIANO 20-2  
Standards: ANSI/AAMI ES60601-1:2005 / EN/IEC 60601-1 / EN/IEC 60601-2-41 / EN/IEC 60601-1-2 / CAN/CSA-22.2 NO. 60601-1 / CAN/CSA-C22.2 NO 60601-2-41 / CAN/CSA-C22.2 NO. 60601-1-6  
Compliance: RoHS  
Conformity: CE  
Listed: MET/cMET

\*For 8-11.5' ceiling heights with field cuttable tube

800-634-0007

## VISIANO 10-1 EXAMINATION LIGHT

- Light output - 50,000 lx / 0.5 m
- Light field - 7" / 0.5 m
- Color temperature: 4400K
- CRI >93
- Mounting options: ceiling, clamp, wall, rail or rolling stand
- 280° turning radius at the luminaire head
- Ergonomic controls on head for one-handed operation
- Electronics integrated for safety and energy efficiency
- Ergonomic handle and high quality gooseneck arm for easy positioning
- Intuitive operation using I/O switch
- Sealed design for easy sanitizing
- Diamond optic design reduces shadows



## HALUX N50 EXAMINATION LIGHT

- Light output - 50,000 lx / 0.5 m
- Light field - 7" / 0.5 m
- 4400K color temperature or color changing option with 3300K, 3800K and 4400K color temps
- CRI >93
- Mounting options: rail, clamp, wall, rolling stand
- Fast cleaning thanks to closed design
- Maintenance-free
- High-quality materials and durable LED technology
- Safe and easy positioning
- Large homogeneous light field for maximum visual comfort
- 5-stage dimmable



Arm Dimensions (in)	
Goosneck	32
Articulating	33

## HALUX N30 EXAMINATION LIGHT

- Light field - 7" / 0.5 m
- Color temperature: 4400K
- CRI >93
- Mounting options: rail, clamp, wall, rolling stand
- Fast cleaning thanks to closed design
- Maintenance-free
- High-quality materials and durable LED technology
- Safe and easy positioning
- Continuously dimmable
- External mains adapter



VISIANO 10-1, HALUX N50, HALUX N30, OPTICLUX  
Standards: ANSI/AAMI ES60601-1:2005 / EN/IEC 60601-1 / EN/IEC 60601-2-41 / EN/IEC 60601-1-2 / CAN/CSA-22.2 NO. 60601-1 / CAN/CSA-C22.2 NO 60601-2-41 / CAN/CSA-C22.2 NO. 60601-1-6

Compliance: RoHS

Conformity: CE

Listed: MET/cMET

www.waldmannlighting.com

# MAGNIFIER LUMINAIRES

## SEE THINGS CLEARLY



OPTICLUX

The skin is the barrier that protects the body against harmful influences. Damage caused by bacteria, fungal infections, viruses or parasites can result in skin diseases that require treatment. In veterinary practices, magnifier luminaires are routinely used to aid in diagnoses or in performing procedures such as removing foreign bodies or sutures from the skin.

### OPTICLUX LED MAGNIFIER

- Color temperature daylight white 6500K
- Magnification 1.88x (3.5 diopters)
- 6.3" specially-treated hard acrylic magnifier lens with protective lens cover
- Color rendering properties: CRI >93, R9 >90, R13 >95
- Light field: 6,000 lux / 0.15 m; Hand held 8,000 lx / 0.15 m
- Continuously dimmable 100% of 10%
- Dimensions: Arm 43", head 11"
- Optional Wood's light: Peak at 365 nm
- Available as a ceiling version\* and pin version with mount accessories for walls, tables, rails and rolling floor stands
- Handheld Wood's light model available
- Optional handheld model charging station



**New!**  
Handheld  
model now  
available!



## TEVISIO LED MAGNIFIER

- 3.5 diopter or 3.5d+8d magnification
- 6" diameter glass magnifying lens
- CRI >90
- Six independent swivel joints for easy head positioning
- Spring-balanced arm with large arm radius
- Continuously dimmable 100% to 10%
- Dimensions: Arm 31" or 39", head 10.4"
- 50,000 hours maintenance-free LED life
- Rated for 20,000+ arm movements
- ETL/cETL approved

## OMNIVUE LED LED MAGNIFIER

- 3.5 diopter 6.38" x 4.13" magnifying lens tilts independently of the light source for optimum ergonomic benefits
- 3 diopter magnifying lens made from optical quality glass
- Three 3.5-watt LED modules provide two light levels
- Dimensions: Arm 35" or 43", head 11.7"
- Optional add-x lenses available for additional magnification
- 5000K color temperature
- ETL/cETL approved



### Mounting Options



TABLE CLAMP



ROLLING STAND



WALL MOUNT



EXTENSION ARM



RAIL MOUNT

TEVISIO  
Standards: UL 153  
Compliance: RoHS  
Conformity: CE  
Listed: ETL/cETL

CSA C22.2#250.4

OMNIVUE  
Standards: UL 153  
Compliance: RoHS  
Listed: ETL/cETL

CSA C22.2#250.4



### Waldmann Lighting Company

9 W. Century Drive  
Wheeling, Illinois 60090  
www.waldmannlighting.com

Telephone (847) 520 1060  
Fax (847) 520 1730  
waldmann@waldmannlighting.com

**Waldmann** **W**  
ENGINEERS OF LIGHT