

# HEAD LED

## SURFACE MOUNT LED FLOOD LIGHT

### FEATURES:

- Designed for wide area light distribution
- High resistance to coolants and lubricants
- Impervious to mechanical vibration
- Rugged anodized aluminum housing
- 4 mm safety glass lens
- Narrow or wide flood options
- 50,000 hours maintenance-free operation

### SPECIFICATIONS:

Voltage	16–32 VDC
Lamping	LED
Operation	connect to external source
Color Temperature	5600 K
Beam Angle	70° or 100°
Luminaire Material	anodized aluminum
Lens Material	borosilicate glass
Dimension	1.9" diameter x .9"
Power Consumption	11 W
Mounting	surface mounted
Connection	M12 connector w/ 8" cable assembly
Protection Rating	IP67
Certification	ETL/cETL
Accessories	See page 68

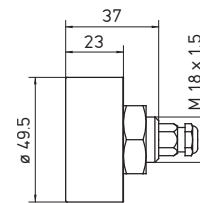

Measurements in millimeters

HEAD LED is an LED flood light designed for integration into machines and equipment requiring a fixed, high-output light beam. The no-nonsense unit has been reduced to its most essential features - without losing luminous power and lighting quality. As a result, HEAD LED can be easily integrated into custom applications and mounting positions. HEAD LED measures just under one inch in height and less than two inches in diameter. There is no space too small for HEAD LED. This small luminaire can light up an entire machine with its 70° or 100° (narrow or wide) flood. It is also impact and vibration resistant, ideal for any machining environment.

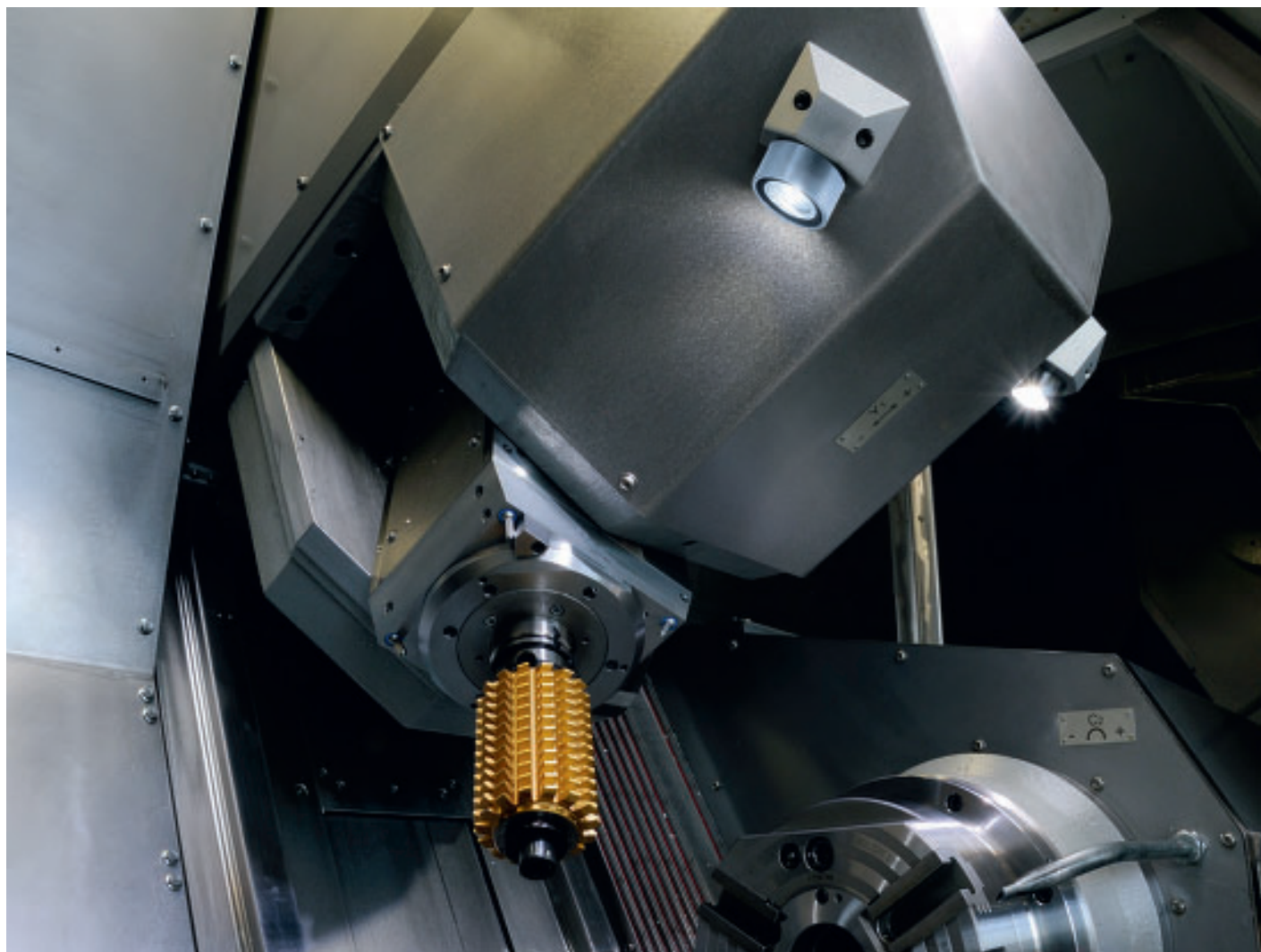

## ORDERING INFORMATION

Version	Beam Angle	Wattage	Lumens	Model	Part #
Wide Flood	100°	11 W	805	MCAYL 4 S	113155000-00646485
Narrow Flood	70°	11 W	805	MCAYL 4 S	113155000-00669609

External Operating Device	Max. Wattage	Input	Output	Part #
Required for 100-277 VAC operation	20 W	100-277 VAC	24 VDC	209585029

Accessories	Item	Type	Part #
	M12 connector plug, straight (included)	A-coded	330603020-00002947