

# Pole Light

## R7P-4LE-SUS

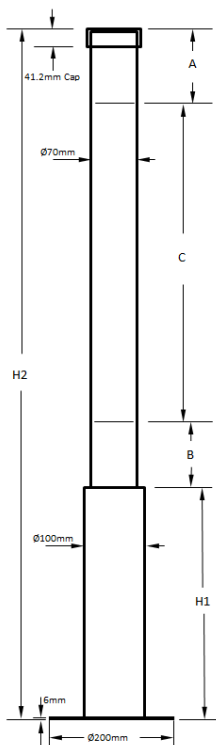

<b>Connected load</b>	120-277V; 50/60Hz
<b>Fitted with</b>	1 x LED Lamp 20W , 2000 lumens Neutral white 3700-4100 K
<b>Work equipment</b>	Electronic ballast
<b>Mains lead</b>	Direct power supply
<b>Luminaire body material</b>	PMMA polymer acrylic satine
<b>Weight(net)</b>	Approx. 10.3 kg (22.7 lbs.)
<b>Fastening</b>	Screw-down flange
<b>Light distribution</b>	All-around illuminance
<b>System of protection</b>	IP 67
<b>Class off protection Special features</b>	I A screw down cable gland for outdoor use



Model	Total Height (H2)	Illuminated (C)	Non-Illuminated		Base (H1)
			(A)	(B)	
R7P	2055mm (80.9in)	1130mm (44.5in)	125mm (4.9in)	125mm (4.9in)	673.0mm (26.5in)

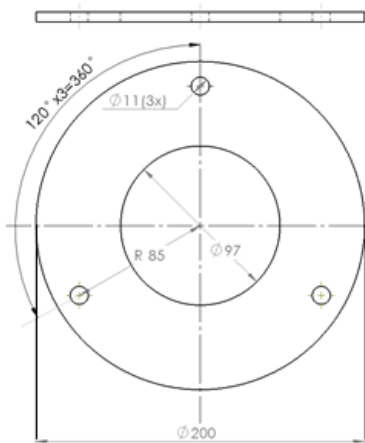

Mounting Base Template  
(Not to scale)