

Pole Light

R7P-2LE-SUS

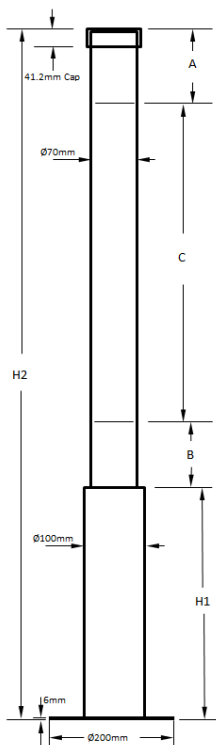

Connected load	120-277V; 50/60Hz
Fitted with	1 x LED lamp 10 W, 850 lumens Neutral white 3700-4100 K
Work equipment	Electronic ballast
Mains lead	Direct power supply
Luminaire body material	PMMA polymer acrylic satine
Weight(net)	Approx. 8.5 kg (18.7 lbs.)
Fastening	Screw-down flange
Light distribution	All-around illuminance
System of protection	IP 67
Class off protection Special features	I A screw down cable gland for outdoor use



Model	Total Height (H2)	Illuminated (C)	Non-Illuminated		Base (H1)
			(A)	(B)	
R7P	1458mm (57.4in)	533mm (21in)	125mm (4.9in)	125mm (4.9in)	673.0mm (26.5in)

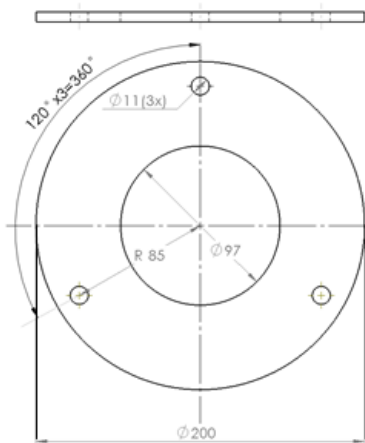

Mounting Base Template
(Not to scale)